

NOTE: THIS DRAWING IS A COPYRIGHT. CONTENTS OF THE DRAWING OR PART THREREOF MAY NOT BE USED OR REPRODUCED WITHOUT THE PERMISSION OF M/S. ARCHTECH.

REV. 05 ON DATE 28.10.2024

< ----- ROAD ----- >

EXISTING BRICK WALL
NEW BRICK WALL
FULL HT SOLID PARTITION
FULL HT GLAZED PARTITION

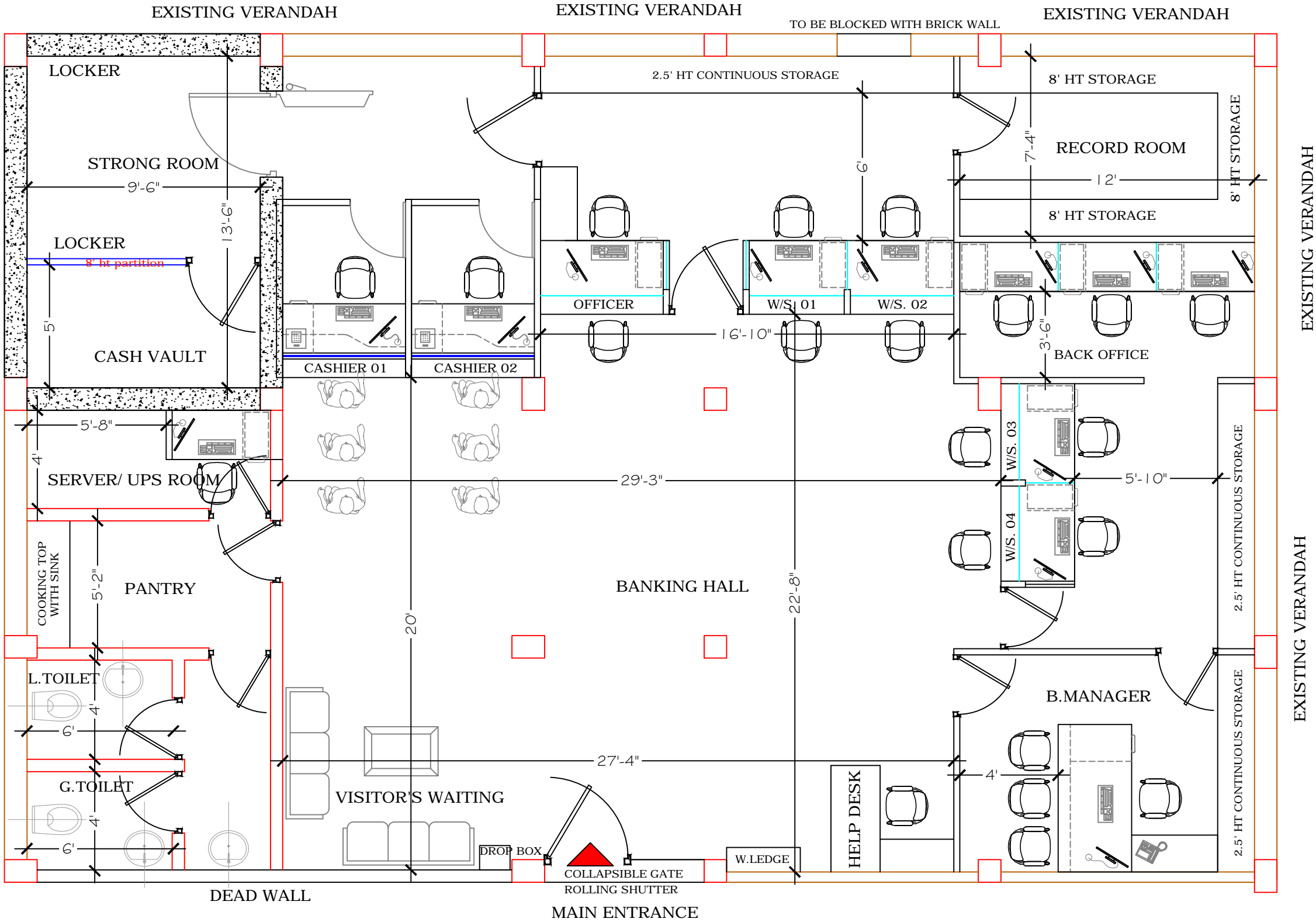

PROPOSED LAYOUT PLAN OF BARPETA ROAD BRANCH (1ST FLOOR), BARPETA ROAD, ASSAM

PROJECT  
DETAIL

PROPOSED FLOOR PLAN OF BARPETA ROAD BRANCH  
CLIENT: CENTRAL BANK OF INDIA, BARPETA REGIONAL OFFICE  
BARPETA MAIN ROAD, BARPETA-781 315 (ASSAM)  
DRAWING FOR APPROVAL  
DRAWING NO. 02



Project dealt by:  
Ar. Awadhesh Shah  
Carpet area: 1560 SFT  
(excluding toilet, col. & walls)  
Date:- 03-07-2023

SEAL & SIGNATURE  
Ar. Awadhesh Shah  
Chief Architect  
M/s. Archtech  
Architects & Designers

FIRM'S NAME & ADDRESS  
ArchTech  
Flat no. E2, Arun Enclave, Om Path,  
Opp. Sanskriti The Gurukul School,  
Ahom Gaon, Guwahati-781035  
Contact no.: +91-70052-05165  
Email ID: awadheshshah123@gmail.com

