

ई निविदा दस्तावेज E- TENDER DOCUMENT

भाग-II (प्राइस बीड) **PART-II** (PRICE BID)

(Rates to be filled in E-procurement portal)

(रेट्स केवल ई-प्रॉक्यूरमेंट पोर्टल में ही भरा जावे)

शाखा सिवान का फर्नीशिंग एवं इलेक्ट्रिकल कार्य FURNISHING AND ELECTRICAL WORK AT SIWAN BRANCH



क्षेत्रीय कार्यालय सिवान
REGIONAL OFFICE SIWAN

PART-II

(PRICE BID)

Rates to be filled in E-procurement portal

(TO BE SUBMITTED ONLINE ONLY)

BILL OF QUANTITY

BILL OF QUANTITIES FOR INTERIOR WORK (PART A)

Sl. No.	DESCRIPTION	UNIT	QTY.
	Note-I: Anti-termite with Chloropyrphos of approved brand and make to be done on all wooden surfaces.		
	Note-II: Wherever painting items are mentioned, these always include the base coats of primer required and a minimum of 2 coats of the Final paint. Anti-termite with Chloropyrphos of approved brand and make to be done on all wooden surfaces.		
1	(FULL HEIGHT PARTITION) :- Providing and fixing fullheight double skin partitions in cabins etc, with frames of 50mmx50 mmx1.5mm thick Aluminium section framework at 600 mm c/c. (intervals of 2'-0" x 2'-0" c/c with provision of bigger members at skirting, fixing to door frames), etc, and covered with 6 mm thick BWP Plywood of approved make covered with various finishing layers as per design and details including outer side with 1 mm thick laminate & inner side with 8mm Calcium Silicate Board /FRC . The boards are to be fixed to the frame work with joints staggered to avoid through cracks to be provided at the horizontal joints of two boards, fixed to the studs using metal to metal flat head screws, including jointing and finishing to a flush finish with recommended jointing compound, jointing tape, angle beads at corners (25 mm x 25 mm x 0.5 mm), joint finisher and one coats putty, two coats of primer and two coats of lustre paint suitable for board as per manufacture's specification and direction of engineer in charge all complete, suitable anchor fastener or metal screws with nylon plugs . The Aluminum section shall be painted with Premium 1st quality paint / polished. Laminates shall have a number of horizontal / vertical grooves and the ply under such grooves shall be painted with approved colours. Opening for communication / conversation shall be provided as required as per detailed design and nothing extra shall be paid / deducted for the same.All doors including sliding doors / openable doors, with all fittings including ISI Marked Floor Springs, Hinges, Bolts,"Godrej Night Latch" / "Godrej Mortice Lock"and Hydraulic door closers etc., shall be included in the same price. Doors shall be of heavy sections matching the partition, and shall have 8.0 mm thick etched glass as per design. All items necessary for completing the above mentioned work are deemed to be included in the scope of work, whether or not they are specifically mentioned in the B.O.Q / tender documents	S.Ft.	184.00

2	<p>(FULL HEIGHT PARTITION)-STATIONARY ROOM & OTHERS- Providing and fixing fullheight double skin partitions in cabins etc, with frames of 50mmx50 mmx1.5mm thick Aluminium section framework at 600 mm c/c. (intervals of 2'-0" x 2'-0" c/c with provision of bigger members at skirting, fixing to door frames), etc, and covered with 6 mm thick BWP Plywood of approved make covered with various finishing layers as per design and details including 1 mm thick laminate. The Aluminum section shall be painted with Premium 1st quality paint / polished. Laminates shall have a number of horizontl / vertical grooves and the ply under such grooves shall be painted with approved colours. Opening for communication / conversation shall be provided as required as per detailed design and nothing extra shall be paid / deducted for the same. All doors including sliding doors / openable doors, with all fittings including ISI Marked Floor Springs, Hinges, Bolts, "Godrej Night Latch" / "Godrej Mortice Lock" and Hydraulic door closers etc., shall be included in the same price. Doors shall be of heavy sections matching the partition, and shall have 8.0 mm thick etched glass as per design. All items necessary for completing the above mentioned work are deemed to be included in the scope of work, whether or not they are specifically mentioned in the B.O.Q / tender documents / drawings.</p>	S.Ft.	219.00	
3	<p>Semi Glazed Partition -Providing and fixing fullheight double skin partitions in cabins etc, with frames of 2" x 2" (finished size) seasoned hardwood members (hollock / malaysian sal) at max. intervals of 2'-0" x 2'-0" c/c with provision of bigger members at skirting, fixing to door frames, etc, all wood work to be treated with 1st quality anti-termite paint, and covered with 6 mm thick Plywood of approved make covered with various finishing layers as per design and details including 1 mm thick laminate. The partition between the level 3'-0" to 7'-0" have 8 mm thk Float glass with 3M Make CRYSTAL engraved etching film. Glass panel as an insert with 3 1/4"x1" thk.beach wood (BW) beading with melamine spray polish including all hardwares etc. complete. .The partition should be firmly fixed on floor/ counter/ wall. Opening for communication / conversation shall be provided as required as per detailed design and nothing extra shall be paid / deduction for the same, All doors including sliding doors / openable doors, with all fittings including ISI Marked Floor Springs, Hinges, Bolts, "Godrej Night Latch" / "Godrej Mortice Lock" and Hydraulic door closers etc., shall be included in the same price. Doors shall be of heavy sections matching the partition as per design. and shall have 8.0 mm thick etched glass as per design. All items necessary for completing the above mentioned work are deemed to be included in the scope of work, whether or not they are specifically mentioned in the B.O.Q / tender documents / drawings. (BM Cabin)</p>	S.Ft.	194.00	

4	(HALF HEIGHT PARTITIONS-FULLY PANELLED) (4'6" ht) The partition between the level 3'-0" to 4'6" have 12 mm thk Float glass .Providing and fixing half height double skin partitions in cabins etc, with frames of 2" x 2" (finished size) seasoned hardwood members (hollock / malaysian sal) at max. intervals of 1'-6" x 1'-6" c/c with provision of bigger members at skirting, fixing to door frames, etc, all wood work to be treated with 1st quality anti-termite paint, and 6 mm thick Plywood of approved make covered with various finishing layers as per design and details including 1 mm thick laminate. (All visible wood to be of 1st quality "gamhar") and shall be painted with Premium 1st quality paint / polished as per instructions of Bank, Ghambhar Frame shall be neatly painted / polished to a glossy finish with premium quality paint / polish. All necessary hardware such as hinges, bolts, etc, and any other hardware required for the wicket door, shall be included in the price. Laminates shall have a number of horizontal / vertical grooves and the ply under such grooves shall be painted with approved colours. Openings for communication / conversation shall be provided as required as per detailed design and nothing extra shall be paid / deduction for the same. All electrical wires, accessories, telephone wires, etc, shall be run in the partition without any extra charges for the same. All items necessary for completing the above mentioned work are deemed to be included in the scope of work, whether or not they are specifically mentioned in the B.O.Q / tender documents / drawings. All exposed wooden surfaces are to be painted with Premium quality paint as per Specifications	S.Ft.	102.00
5	(COMPUTER CASH AND CASH CAGE PARTITIONS - FRONT) Providing and fixing cash cage glazed partition on top of cash counter facing the customer with 12 mm thick Toughened Glass glass (Modiguard) fixed in a frame of 2" x 3" teakwood on all three sides, duly polished, all beading etc. as required, all cutting of glass as required, all complete.	S.Ft.	45.00
6	(COMPUTER CASH AND CASH CAGE PARTITIONS - SIDES & REAR) Providing and fixing cash cage partition, as per specifications given in Item No. 1a above, modified in height and the openings required to suit the requirements of cash cages, with the exception that in addition to 5.0 mm glass, aluminium mesh shall be given in all cash cage partitions, etc, from 4'-0" to 7'-0", along with supporting members all doors, as per specifications given in Item No. 1 above, all hardware for doors including door closers, godrej night latches which , all complete. The front of the cash cage shall be done in a decorative design, as shown in the attached drawings and details.	S.Ft.	324.00
7	(EXECUTIVE TABLES) Providing and Placing new executives tables alongwith matching credenza of plan size (basic) as given below and credenza of plan size as given below, table top to be made of 19 mm thick plywood of approved make, edged with beading of 2" x 1-12" approx), cut to required shape, top of table to have 1.0 mm thick laminate, and teakwood beading to be polished to required colour and finish. Table to have a vertical modesty panel of 19 mm thick plywood of approved make laminated/Plain with laminate (1.0 mm thick) from the outer side and painted with minimum 2 coats of premium 1st quality paint on the inner side. Modesty partition to have 1st quality beading on top as per design and specifications and Quality Enamel paint over appropriate priming coat on the internal surface.		

	Laminate to have a no. of grooves as per design and drawings. A chest of drawers shall support the table on 1 side (except in the case of staff tables of 4'-0" width, where the table shall be supported on one side by the credenza unit) integrally connected to the modesty partition, made of 19 mm thick commercial plywood of approved make, drawers to slide on drawer slides (EBCO / Equivalent), and made of 19 mm thick grade bwp board for all sides and bottom cabinet shutters of 19 mm thick commercial plywood of approved make, cabinet hinges to be t-type, self closing, EBCO / Equivalent, all edges of all blockboard / plywood to be sealed with 1st quality teakwood edging, including blockboard members touching the ground.		
	Drawers and cabinet shutters to be laminated on all external surfaces with 1.0 mm thick laminate, and painted on all visible internal surfaces with premium 1st quality enamel paint as Specified above. All drawers and cabinets (both in tables and credenza) to be provided with high quality 'Gogrej' locks, and high quality handles as per Item No. B above. Drawers and cabinets, cabinet shutters, etc. to be Shuttters will be hung by auto-closing hinges, locks, magnetic door catcher and satin finished S. S. handles etc. of approved make as described in table specifications above, including all finishing details, and one glazed cabinet shutter in 1st Quality Teakwood frame, finished with laminate also to be laminated with 1.0 mm thick laminate grooves as / design. Keyboard unit as per design and specification to be included in the rate.		
	Laminate pasting pattern /design as per banks design guideline/detail/reference.		
a)	Senior Manager (6'-9" x 3'-0") 12 mm thk. with top glass	Each	1.00
b)	Officer Table (4'-6" x 2'-6") & (5'-0" x 2'-6")	Each	3.00
c)	Credenza (1'3"x3'0") & (1'3"x3'6")	Each	4.00
d)	Full Ht cabinet;-(elevation area calculation))	SFT	84.00
e)	Sill Ht cabinet;-(elevation area calculation))	SFT	62.00
f)	Centre table (3'0"x2'0")	Each	1.00
g)	Credenza (1'3"x4'0")	Each	1.00
8	(COUNTERS) Providing and fixing COMPUTER COUNTERS (formerly from as LEDGER COUNTERS) made out of 19 mm thick plywood of approved make and as per the attached drawing, all complete with 1.0 mm thick laminate on all visible surface, tabletops, customer top, etc, and all drawers etc. to be painted with 1 coat of primer and 2 coats of 1st quality enamel paint). 12 mm thick glass, MODIGUARD/ASAHI, branded, to be used on top of the COMPUTER COUNTER. Keyboard Tray to be provided on Special Keyboard Slides, and wristrest to be given. Drawer Slides to be used for all drawers. All locks to be of Godrej / Linc. All drawers, cabinets, Keyboard, etc. to be lockable. Footrest to be provided. (See Detailed drawing attached). The Front of the Computer Counter shall have decorative finishing in ply and laminate as shown in the drawing attached.	R.Ft.	21.00

9	Cash counter :- Size 5'0"x6'0"x3'8" (LxWxH) , table top should be in two levels, the top level shall be 1.5' as customer top at 3'10" level. The front shall be 12 mm thick toughened glass up to 7' level. All exposed glass face to be machine polished. The counter shall be made of 18mm bwp ply board, with 1.0mm laminate as per drawing detail enclosed, storage unit with drawers, and keyboard and pencil drawer on channels, cable manager, and laminated apron to match décor. Drawer unit and verticals made out of 18mm ply board with keyboard drawers and 3 cash drawers (18"Wx24"Dx8"H) with note separator made out of 12mm ply board for footrest finished with enamel paint .All drawers to be provided with Godrej lock & SS handle of approved make. The exposed side of front faced, drawer front shall be finished with 1mm laminate as per drawing enclosed. The inside shall be French polished.	R.Ft.	10.00
10	(NOTICE BOARD) Providing and fixing a notice board near the Waiting area, frame to be made of 1st quality hardwood, and infill of 12 mm thick 'Celotex, board, duly covered with "Matte" quality cloth of approved colour and make. Visible surfaces of Frame to be painted with "Premium 1st Quality Paint" in approved colour and shade, and internal frames and internal surface of celotex board to be painted with priming coat. The frame is to be securely fixed to the wall, all complete as per directions for the Architect / Employer. Size: 3'-6" x 2'-0".	Each	2.00
11	Main Entrance Door: Full.ht.Glass Partitions (WITH DOOR)Entrance side Providing and fixing 12 mm thk. full ht. Toughened Glass partitions with etched horizontal liner of 1"ht. and 1/2"clear space in between as per design ,Rate should be inclusive of additional Alluminium profile fixed in the flooring and above finished false ceiling level with necessary patch fittings as required to hold the glass partition. All exposed edges surfaces should be machine polished edges. The Rate shall be also inclusive of floor spring ,necessary hardware 3'-0"ht. Matt steel door handles with floor locking arrangement of Enox co. etc. Complete as per designs and details from the Architects.The rate shall be Inclusive of Horizontal Etched Lining in between 3' to 6' ht. horizontal etched lining of 1"frost and 1/2" clear as per design etc. complete. Supplying and fixing banks logo – sticker as per drawing and design. Glass wall as per design and instruction by Architect /Enginee	S.Ft.	92.00
12	(SUGGESTION BOX) Providing and fixing one suggestion box, made with 12 mm ply as per standard design and specifications of the Bank, fully complete, with enamel painting, lock, lettering on top, etc.	Each	1.00
13	Providing and fixing Cheque writing/slip rack projected/supported from wall6'0" x1'-3" and a C.T. as per design with suggestion box,first aid box,sugestion box.	Each	1.00
14	(CHECK DROP BOX) Providing and fixing one suggestion box, made with 12 mm ply as per standard design and specifications of the Bank, fully complete, with enamel painting, lock, lettering on top, etc.	Each	1.00
15	FALSE CEILING		
i)	Gypsum board false ceiling with Vertical band /drop of 4" Gypsum board false ceiling with Vertical band /drop of per detail drawing & instructions of Architect		

	<p>Providing and fixing in position Gypsum Board False Ceiling including Two coats of Plastic emulsion Paint of appd.quality as per manufacturer's specifications and instructions with 12.5 mm thick 'Gypboard' Screw-fixed to the underside Of suspended G.I. grid. G.I. grid should be Constructed and suspended from the main ceiling as per manufacturer's instructions and as per specifications using Original Co. Specified Framework Sections G.I.24 gauge The Gypboard should be fixed to G.I. grid with 25 mm long Drawali Screws. The 'Gypboard ' to be used should be 12.5mm thick tapered edge boards. The boards should Be taped and filled from underside to give smooth, seamless ceiling. The rate should include necessary additional ceiling sections and intermediate channels openings for light fixtures, A.C. ducts, vertical drops, offsets. etc.</p>		
	<p>Additional Intermediate channels should be fixed to strap hangers for additional support to prevent strap hangers from buckling/swaying at every 1200 mm. Item to be completed in all respect including necessary sleeves for ducts finishing of joints cut outs supports for A.C. grills, light fixtures, speakers etc.Make: Gypsum board-India Gypsum. Panint-Asian/ ICI The rate should include necessary additional ceiling sections and intermediate channels openings for light fixtures, A.C. ducts, vertical drops, offsets.and with two coats of putty, two coats of approved primer, and three coats of approved lustre pain</p>	SQ.FT.	517.00
ii)	Grid False Ceiling		
	<p>Modular False ceiling:- Providing and Fixing 15 mm thick densified regular edged eco friendly light weight calcium silicate false ceiling tiles of approved texture of size 595 x 595 mm in true horizontal level, suspended on inter locking metal grid of hot dipped galvanised steel sections (galvanising @ 120 grams per sqm including both side) consisting of main 'T'runner suitably spaced at joints to get required length and of size 24x38 mm made from 0.33 mm thick (minimum) sheet, spaced 1200 mm centre to centre, and cross "T" of size 24x28 mm made out of 0.33 mm (Minimum) sheet, 1200 mm long spaced between main'T' at 600 mm centre to centre to form a grid of 1200x600 mm and secondary cross 'T' of length 600 mm and size 24 x28 mm made of 0.33 mm thick (Minimum) sheet to be inter locked at middleof the 1200x 600 mm panel to from grid of size 600x600 mm, resting on periphery walls /partitions on a Perimeter wall angle precoated steel of size(24x24X3000 mm made of 0.40 mm thick (minimum) sheet with the help of rawl plugs at 450 mm centre tocentre with 25 mm long dry wall screws @ 230 mm interval and laying 15 mm thick densified edges calcium silicate ceiling tiles of approved texture in the grid, including, cutting/ making opening for services like diffusers, grills, light fittings, fixtures, smoke detectors etc., wherever required. Main 'T' runners to be suspended from ceiling using G.I. slotted cleats of size 25x35x1.6 mm fixed to ceiling with 12.5 mm dia and 50 mm long dash fasteners, 4 mm G.I. adjustable rods with galvanised steel level clips of size 85 x 30 x 0.8 mm, spaced at 1200 mm centre to centre along main 'T', bottom exposed with 24 mm of all Tsections shall be pre-painted with polyster baked paint, for all heights, as per specifications, drawings and as directed by Engineer-in-Charge.</p>	SQ.FT.	988.00

16	Column Panelling : Column & Wall panelling within 1 ½"X1" hardwood fixed to the column and then finished with 6mm ply & above should be laminated with 1.5mm laminate of approved make and as per drawings and instruction of the architect. A wooden cornice of size 3"X2" has to be fixed on the edge and around the pillar as per design duly polished as per instructions of the Architect. (upto 8'0" height)	SQ.FT.	441.00
17	Vertical blinds : Providing & fixing levelor 10mm vertical blinds having top rail 39mmX34mm hgh with wall thicknessof 1.2mm having 25mm decorative insert. Control unit shall be of Derlin. Plastic runner shall be moulded from Derlin plastic with artification head rail & the top end of the louver fabric shall be polyster viscose/polyster yarn dyed in fast colour with or without protective coating on louvers with chemical for stain resistance and soil repetancy and shall have GI weight and steel/polymer ball chain for spacing. The top rail should be fixed on bracket of 14 SWG galvanized spring steel fixed firmly on walls by nylon plug and screw as per approved design and direction of the Architect.(Vista, Universal)	SQ.FT.	0.00
18	Panel box covering : Shall be made up of 19mm th BWP boarer free ISI marked -Fire resistant ply on all the sides. shutter shall be of 19mm th block board of BWPgrade ISI marked-Fire resistant (Minimum 2 hr.) and shall have holes 1/2" dia (25nos.) for ventilation and have glass piece (9"x9") for meter reading and shall be finished with 1.00mm laminate of approved shade on all exposed sides and inside finished with 0.8 mm thick laminated. The rate is inclusive of all locks of Godrej or equivalent make, SS tower bolts, SS handles, with Aircon Louvers 6" powder coated aluminium Louvers. All complete as per directions for the Architect /Bank ,heavy duty SS hinges etc.all hardware complete. Prior confirmation shall be obtained from the officer in charge for all the hardware, locks and fixture etc, complete. (Note :- Box should not touch the ground)	SQ.FT.	42.00
19	SHUTTER BOX COVERING -Shutter covering with ACP (aluminium composite panel) of 4mm thk. approved color & make with aluminium framing as/required with the provision of rolling shutter maintenance trap door,ele. point all complete job as per standard & specification	SQ.FT.	72.00
20	Dismantle & Removal of existing partition ,false ceiling, counters etc in Branch Room.debris from site, carrying and disposal of malba to dumpyard. as per bank/branch incharge direction.	LS	1.00

BILL OF QUANTITIES FOR ELECTRICAL WORKS (PART B)

SL. NO.	ITEM OF WORK	UNIT	QTY
SUB HEAD - I (WIRING)			
1	Point wiring with 1100 V grade 3 nos. single core 1.5 sq.mm.FR and 1.5 sq.mm.for earth PVC insulated stranded copper conductor wire (IS:694) through suitable size PVC conduit (ISI marked)by thred cutting, complete with junction box, circular box, elbows, bends, couplers and other accessories on surface above false ceiling or concealed by chase cutting on wall from light & fan switch board to light, fan & 6A socket outlet on the same switch board or separately mounted switch board. The work includes supply and fixing of all materials such as modular type 6A switch for light and fan point, 6A 2/3 pin shuttered socket outlet with switch in each switch board for wall fan , 3 plate ceiling rose / angle or batten holder etc. as required. The point wiring also includes circuit wiring with 1100 V grade 2 nos. single core 2.5 sq.mm.FR + 1 no. single core 1.5 sq.mm.FR PVC insulated stranded copper conductor cable (IS:694) through suitable size PVC conduit as described above from DB to switch board, interconnection, mending good all damages to original finish, painting etc. (maximum ten switch for one circuit)		
a	1 Light control & ,ceiling fan ,exhaust fan by 1 switch	Each	40
b	2 Light control by 1 switch	Each	12
c	Wall fan point with 6A 3 pin modular socket & 5/6 amps modular switch	Each	12
-			
2	Supply & fixing suitable size GI box with modular plate and cover in front on surface/ in recess i/c pvdg & fixing 5 pin 5/6 amp modular socket outlet and 5/6 amps modular switch, connection, painting etc as reqd.	Set	8
3	Supply & fixing AC controller unit consisting of one no 25 amp AC controller having overload protection starter, one no 20/25 amp SPN MCB and socket outlet, all fixed on a modular plate complete with metal box and recessed in wall as reqd. With Wiring for A.C. Point with 2 x 4 sqmm FR PVC insulated copper conductor single core cable in surface/recessed PVC conduit / PVC Casing - n Capping along with one no 4 sq mm FR PVC insulated copper conductor single core cable for loop earthing as required	Each	6

5	Supply and laying of 4x10 flexible wire in PVC Conduit (LT Panel to Light feed D.B. & Lt Panel To UPS Panel) Supply and laying of 3x10 sq mm + 1x10 sq mm FR (Fire Resistant) stranded Cu. Wire in PVC Conduit (HMS Grade) through wall / floor / above false ceiling / partition etc. The work shall also include for cutting chase for conduits and moulded boxes, if required, in the wall/ floor (Without damaging the building/wall) along with clamping the conduit at every 600mm interval & finally finishing the surface & matching the same with the existing surface. The rate should include the cost of all materials, labour, T&P, scaffolding, shifting of furniture, carting away the debris and cleaning the floor etc.	RM	45
6	Sub Main Wiring from. Raw D.B with 2 x 6 sqmm FR PVC insulated copper conductor single core cable in surface/ recessed PVC conduit / PVC Casing - n Capping along with 1 x 6 sq mm FR PVC insulated copper conductor single core cable for loop earthing as required. The rate should be quoted considering wastage. The measurement shall be taken to the place where the wire start and end.	Mtr.	110
7	Supply & fixing suitable size GI box with modular plate and cover in front on surface/ in recess i/c pvdg & fixing 6 pin 15/16 amp modular socket outlet and 15/16 amps modular switch, connection, painting etc as reqd. with Circuit wiring with 2 x 2.5 sqmm FR PVC insulated copper conductor single core cable surface/ recessed PVC conduit / PVC Casing - n Capping along with one no 1.5 sq mm FR PVC insulated copper conductor single core cable for loop earthing as required. With	Each	6
8	Supply & fixing remote controlled call bell buzzer suitable for 230 V AC/ Battery operated with remote type bell push as reqd.	nos.	1
9	Supply & fixing of computer point with 3 no. 5 pin 5/6 amp modular socket with modular type switch for UPS Power and 2 no. 5 pin 5/6 amp modular socket with modular type switch phenolic laminated sheet suitable size PVC/G.I. box for RAW Power. As per instruction of Bank/ Ele. Er./ as required including their wiring for UPS as well as RAW Power socket for computer with 2 x 2.5 sqmm FR PVC insulated copper conductor single core cable in surface/ recessed PVC conduit / PVC Casing - n Capping along with one no 2.5 sq mm FR PVC insulated copper conductor single core cable for loop earthing as required.	Each	14

10	Supply & fixing of computer point with 3 no. 5 pin 5/6 amp modular socket with 1 nos 15 amp modular type switch for UPS Power. As per instruction of Bank/Ele.Er./as required including their wiring for UPS as well as RAW Power socket for NETWORK SWITCH, CCTV & FIRE ALARM SYSTEM with 2 x 2.5 sqmm FR PVC insulated copper conductor single core cable in surface/ recessed PVC conduit / PVC Casing - n Capping along with one no 2.5 sq mm FR PVC insulated copper conductor single core cable for loop earthing as required. The circuit wiring is to be done from UPS PANEL till the location of NETWORK SWITCH, CCTV & FIRE ALARM SYSTEM & connected to 6/10amp mcb mentioned in SUB HEAD II point no-4.	Each	3
11	Supply & fixing of approved make including square face plate and M.S. housing box with RJ-11 socket etc complete in all respect conduits as required.(Each Section Head work station have 2 no. of RJ 11 Socket) with Supplying and drawing 2 pair 0.5 sqmm FR PVC insulated annealed copper conductor, unarmored telephone cable in PVC conduit as required.	Each	11
12	Providing and fixing of telephone tag block (Krone type) of 50 pair housed in GI box with cover of suitable size including termination	Each	1
13	Supply & fixing Of 15Amp Modular Switch & Socket with modular type switch phenolic laminated sheet suitable size PVC/G.I. box along with 15 TOP outside Strong Room. The point wiring also includes circuit wiring with 1100 V grade 2 nos. single core 2.5 sq.mm.FR + 1 no. single core 1.5 sq.mm.FR PVC insulated stranded copper conductor cable (IS:694) through suitable size PVC conduit from this box to strong room switch board. The wiring from light DB to this box is already included in point wiring description.	Each	1
14	Supply & laying for sub main from L.T line & DG line following sizes and core PVC/XLPE insulated PVC sheathed, heavy duty, armored electrical cable with aluminum conductor for working voltage up to and including 1100 volts.(Conforms to IS:1554.part-1) with 8 no. SWG die bare copper conductor wire for loop earthing, proper laying on wall or roof, thumbnail clipping and use proper size cable gland for cable sport etc. as required. all complete as per instructions of Elec.Er. / Architect.		
A	35 sq.mm, 3.5 core LT Cable	Mtr.	40
B	16 sq mm,3.5 core LT Cable	Mtr.	0
SUB HEAD - II (DISTRIBUTION BOARDS & PANELS)			
1	Supplying & Fixing following ways three pole and neutral sheet steel MCB DB, 415 volts on surface/ recessed complete with tinned copper busbar, neutral busbar, earth bar din bar detachable gland plate interconnections, phosphatised and powder painted i/c earthing etc as reqd. (But without MCB / RCCB/Isolator)		

	a) 4+18 Way double door TPN DB Suitable for MCCB as Incomer.	Each	1
	B) 16 Way double door SPN DB.	Each	2
2	Supply & fixing 5 amps to 32 amps rating 240 V 'C' series MCB suitable for inductive load of following poles in the existing MCB DB complete with connections, testing and commissioning etc as reqd.		
A	40 A 10 KA FP MCB "C"	Each	1
B	40 A 10 KA DP MCB "C"	Each	2
C	6/10 A 10 KA SP MCB "C"	Each	42
3	<p>Supply & fixing of indoor cubicle extensible type fully compartmentalized Distribution panel suitable for operation on 415 volts 50 Hz 3 phase 4 wire AC distribution system, suitable for 35 KA short circuit rating, confirming to IP:42 degree of protection, made up of 1.6 mm thick CRCA sheet, wall/ floor mounted, dust & vermin proof enclosure, having hinged and earthed cover on front, having neoprene gasket/ katings stuck to the doors, duly painted with 65- 75 microns thick dry epoxy powder paint after 7 tank process of degreasing, derusting etc comprising of the following switchgears complete with all interconnections with suitable size of copper strip/hard drawn PVC insulated copper cable i/c keeping the panel in position, minor civil works as necessary, painting, sign writing etc complete as required (as per specifications of Panel attached)</p> <p>TEST REPORT: FOLLOWING REPORTS HAVE TO BE PROVIDED BY THE VENDOR AT THE TIME OF SUBMISSION OF BILL:.</p> <p>1) FINAL AS BUILT PLAN IN THREE COPIES DRAWN TO THE SCALE, PRINTED IN CASE OF CAD AND BLUE PRINT, IN CASE OF MANUAL DRAWING.</p> <p>2) QUALITY REPORT INDICATING THE ITEMS USED WITH THEIR MAKES.</p> <p>3) PANEL MANUFACTURER'S CPRI TEST REPORT.</p> <p>4) ROUTINE TEST REPORT OF PANEL FOR IR & HV TEST.</p> <p>5) GUARANTEE/WARRANTY CARD OF PANEL MANUFACTURER.(Panel Size- H-1400mm, W-900mm & D-300mm)</p>		
	INCOMING:		
	a) 100 amp 4 pole MCCB not less than 25 KA having Thermo magnetic type release for a range of 80% to 100% for Overload and short circuit complete with rotary handle etc as reqd.: 1 no		
	b) 63 amp 4 pole heavy duty I-II-I type cubicle changeover switch: 1 no		
	METERING:		
	a) Multifunctional meter displaying A/V/PF & Hz along with 3 nos Suitable size CTs & HRC type protection fuse etc as reqd: 1 nos		

	c) LED type phase indicationg lamp in phase distinguishing colors with HRC fuse : 6nos		
	BUS BAR:		
	Main Bus Bar: 4 strip 200 amp bus bar made of electrical grade aluminium strip enclosed in separate bus bar chamber, provided with DMC/ SMC bus bar support duly insulated with heat shrinkable sleeves in distinct colours as reqd: 1 set		
	Emergency Load Bus Bar: 4 strip 150 amp bus bar made of electrical aluminium copper strip enclosed in separate bus bar chamber, provided with DMC/ SMC bus bar support duly insulated with heat shrinkable sleeves in distinct colours as reqd: 1 set		
	OUTGOINGS:		
	32 amp, 10 KA D Series FP MCB : 3 nos.		
	32 amp, 10 KA D Series DP MCB: 3 nos.		
	25 amp 10 KA C series SPN MCB: 9 nos.		
	40 A rotary type Phase selector: 2 no		
	40 amp DP Manual Change Over For UPS Charging-1 nos.	Set	1
3	Supply & fixing of indoor cubicle type UPS panel suitable for operation on 415 volts 50 Hz, 3 phase 4 wire AC distribution system, AC supply, suitable for 35 KA short circuit rating, confirming to IP:42 degree of protection, made up of 1.6 mm thick CRCA sheet, wall/ floor mounted, dust & vermin proof enclosure, having hinged and earthed cover on front, having neoprene gasket/ katings stuck to the doors, duly painted with 65- 75 microns thick dry epoxy powder paint after 7 tank process of degreasing, derusting etc comprising of the following switchgears complete with all interconnections with suitable size of copper strip/hard drawn PVC insulated copper cable i/c keeping the panel in position, minor civil works as necessary, painting, sign writing etc complete as required. (as per specifications of Panel attached)	Set	1
	INCOMING:		
	a) 63 amp 4 pole MCCB 10 KA D series.: 1 no		
	METERING:		
	a) Digital Volt meter displaying voltage of each phase along with 3 nos HRC type protection fuse etc as reqd: 1 nos		
	UPS INPUT & OUT PUT		
	b) 6/10 A 10 KA SP MCB "B": 3 nos for NETWORK SWITCH, CCTV & FIRE ALARM SYSTEM to be connected with required wiring with UPS output		
	UPS INPUT & OUT PUT		
	4 no 40 A SPN MCB 10KA with 4 no 40 amp Industrial type socket out let and Top with connection o/g MCB with PVC insulated copper conductor wire as required (For 2 no. main input and 1 no. output)		

1	Supplying, installation, testing & fixing of 6W/9W LED batten suitable for indoor application.	Each	4
2	Supplying of stepped type electronic fan regulator on the existing modular plate switch box i/c connection but excluding modular plate etc as reqd.	Each	2
3	Supplying of 36W LED (2'X2') surge protection LED luminaire suitable for armstrong ceiling and grid ceiling complete with separate electronic drive/approved make by architect/Ele.Consultant etc as reqd	Each	20
4	Supplying, installation, testing & fixing of recess mounted circular LED (dia-6") downlighter 12/15 Watt LED suitable for armstrong ceiling and grid ceiling complete with separate electronic drive/approved make by architect/Ele.Consultant etc as required.	Each	24
5	Supplying, installation, testing & fixing of 1X36 W LED tube light fitting powder coated batten with PC tube	Each	6
6	Supplying, installation, testing & fixing of Exhaust fan 300mm sweep HEAVY DUTY EXHAUST make- CROMPTON / approved equivalent. (UPS ROOM, TWO TOILETS)	Each	4
7	Supplying, installation, testing & fixing of 1200 mm sweep energy efficient ceiling fan, connection with 1.5 sqmm PVC ins copper condtr, testing, commissioning etc as reqd.	Each	2
8	Supplying of oscillating and tilting type wall bracket fan of 400 mm sweep i/c fixing the same on wall, connection with 1.5 sqmm PVC insulated copper conductor, testing, commissioning etc as required.	Each	11
9	Supply and installation of flexible LED strip light complete with driver unit, 230v,50 Hz ,in the form of or with profile complete.	RMT	60
SUB HEAD - IV (SUPPLY & MAKING OF EARTHPIES, REMOVING OF ITEMS, RUBBER MAT)			
1	Providing chemical/mineral maintenance free earthing system comprising of copper coated earth electrode 3 metre length and 17.2 mm outer dia along with 25 kg earth conductivity enhancing back fill mineral compound for earth inspection pit etc. as required. OR Earthing with copper earth plate 600 mm X 600 mm X3 mm thick including accessories, and providing masonry enclosure with cover plate having locking arrangement and watering pipe 2.7 metre long etc.with charcoal / coke and salt as required.	Set	2
4	S/L 4 mm dia copper wire on surface or in recess as reqd.	Mtr.	42

5	High voltage insulation mat are relatively thin mats of thickness (2mm to 3.5mm) made of elastomeric polymers materials having a high insulation resistance, thus imparting total safety of human being from any leakage current.(UPS Room)	Sqft	60
6	KIT-KUT:- Supply and fitting of 3 nos. 200 Amp. Porcelain Kit Kut on suitable size of wooden board including connections etc. as required.	SET	1
SUB HEAD - V (SUPPLY & FIXING OF NETWORKING (DATA CABLE) WORKS)			
1	Supply & fixing of approved make including square face plate and M.S. housing box with RJ-45 socket etc complete in all respect including cat-6 Data cable conduits, identification of the hub		
	a) RJ-45 socket	Set.	14
	b) Cat-6 Data cable with PVC conduit	Mtr.	350
2	Supply & fixing Commissioning of 9U rack for 24 line Net all complete as required.	Set.	1
3	Supply & fixing Commissioning of 2 Meter Patch Cord as required, all complete as per requirement.	Set.	15

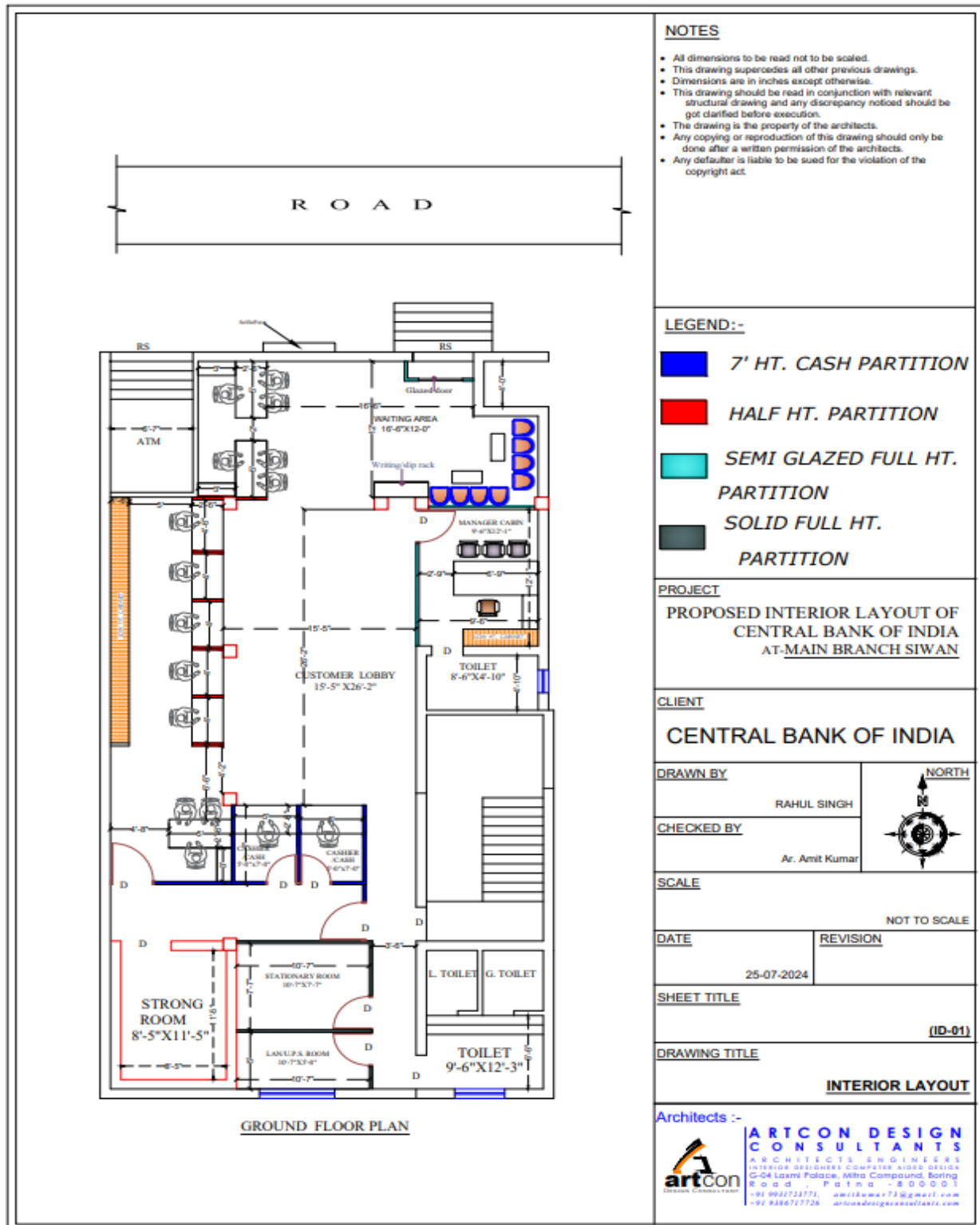

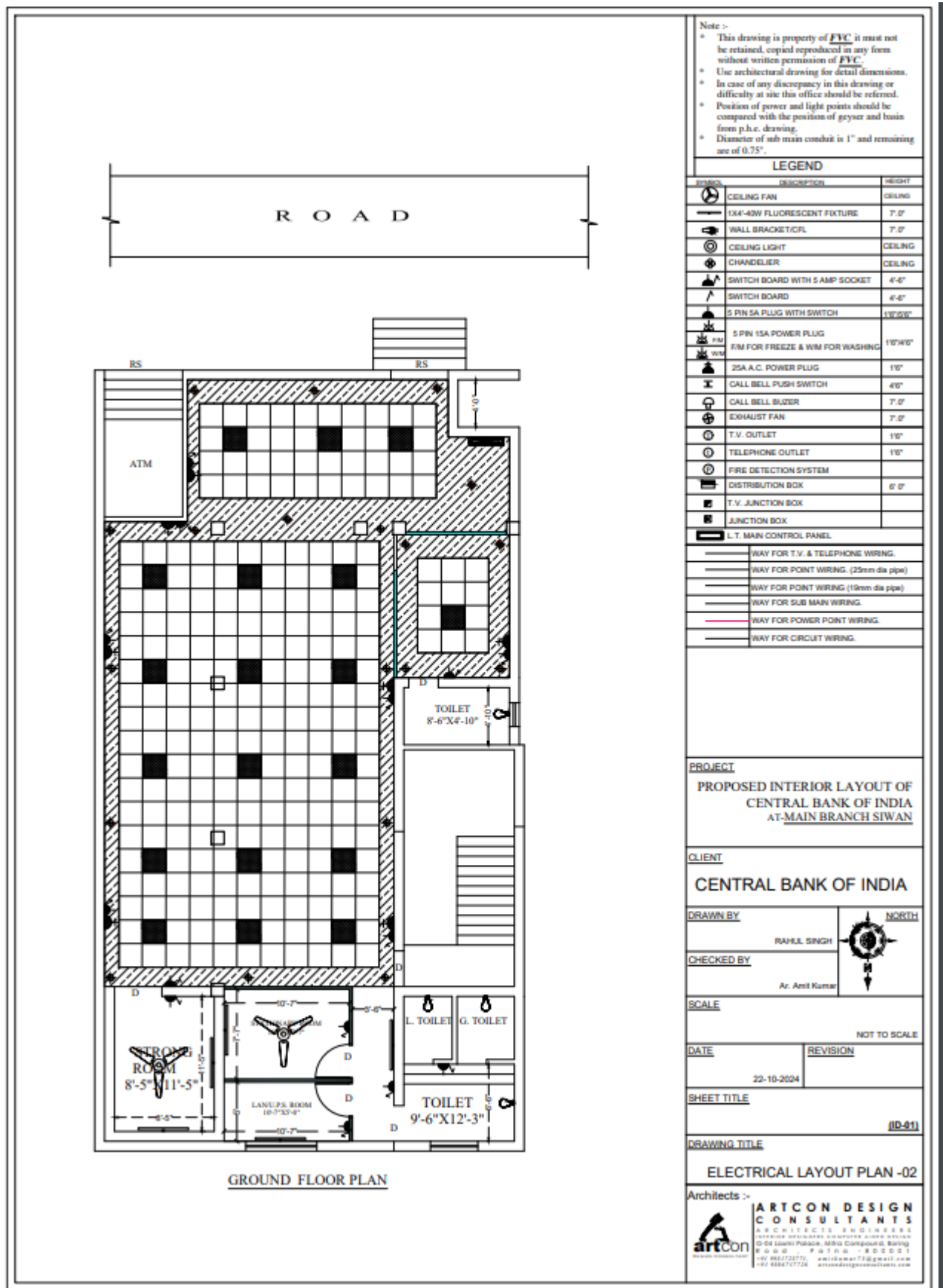

ABSTRACT**SUB: FURNISHING AND ELECTRICAL WORK AT SIWAN BRANCH**

Sr.	Particulars	Amount
1	Furnishing work (Part-A)	<i>To be filled in E-procurement portal only</i>
2	Electrical and allied work work (Part-B)	
3	Total (1+2)	
4	Discount if any	
5	TOTAL (3 - 4)	

**The Prices quoted must be inclusive of all taxes, duties labour, transporation etc. except GST. GST will be reimbursed as applicable.*

Seal & Signature of Firm,